



INSUGLAZE TYPES

TYPE SQ



3m Lamina/Styrofoam/3m Lamina

TYPE TR



3m Lamina/Styrofoam/0.3mm Plastics/Steel



NSU GLAZE®

Thermal Performance INSUGLAZE TR	
Panel Thickness	'U' Value (W/m ² K)
20 mm	1.25
24 mm	1.05
32 mm	0.8
44 mm	0.6
59 mm	0.45
72 mm	0.35

Standard 20mm Double Glazed Unit 2.8 W/m²K

Introduction

Insuglaze panels give architects and designers a high performance, aesthetically pleasing insulated panel that can be used on a wide range of projects. They are suitable for use with all window systems including PVC-U, steel, timber and aluminium.

Adhesive

Insuglaze is laminated using a sophisticated single part moisture curing polyurethane adhesive. This provides a structural bond between the face and styrofoam core. The adhesive is solvent free and, therefore, has a minimal impact on the environment when sprayed.

Insulating Core

Insuglaze panels are supplied using an extruded polystyrene, Styrofoam, with its unique blue colour. Insuglaze is resistant to moisture and will, therefore, continue to provide effective insulation for many years. Its high compressive strength combined with its structural integrity ensure that Insuglaze panels will be both flat and capable of withstanding high wind loading.

© Registered Trade Marks

Insuglaze is a registered trademark of Panel Systems Limited

Styrofoam is a registered trademark of Dow Chemical Company Limited

Quality

All Insuglaze panels are manufactured to stringent quality checks. All manufacturing procedures are fully documented and are approved to ISO 9002.

Surface Finish

A protective film can be supplied on both faces to ensure that Insuglaze panels can be cut without damaging the face.

Cutting (Type SQ only)

Insuglaze panels can be cut using good quality tungsten carbide tip blades. Best results are achieved with the panel clamped down.

Specification Example

Product: *Insuglaze TR*
 Thickness: *59mm*
 Edge thickness: *24mm*
 Colour: *To be determined*
 Manufacturer: *Panel Systems Ltd.*



Panel Systems Limited

Units 3-9 Welland Close
 Parkwood Industrial Estate
 Rutland Road
 Sheffield S3 9QY

Telephone: (0114) 27 52 881
 Facsimile: (0114) 27 68 807 / 27 86 840
 eMail: sales@panelsystems.co.uk
 Website: www.panelsystems.co.uk



NSU GLAZE®

Insuglaze in an insulated glazing panel based on Lamina, an external high pressure laminate and Styrofoam an extruded polystyrene

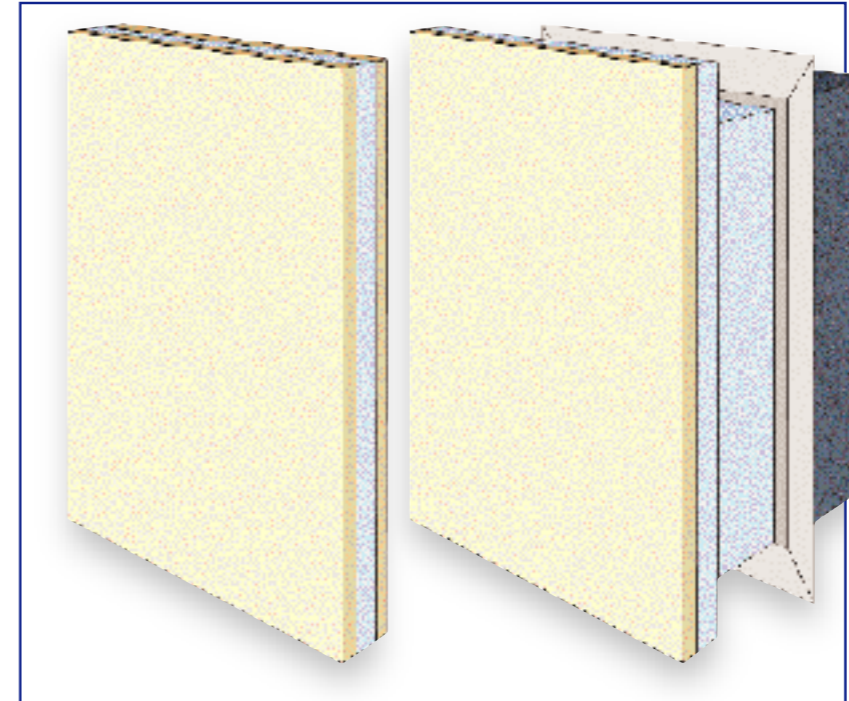

Physical Properties

- **Size:**
Max. 2800 x 1850 mm
- **Overall Thickness:**
20 mm to 100 mm
- **Edge Thickness:**
To suit glazing system
- **Lamina Thickness:**
3 mm
- **Thermal Conductivity:**
Styrofoam 0.027 w/mk
- **Weight:**
5 kg/m² to 9 kg/m²
- **Colours:**
A separate leaflet is available with our standard colours. These are held in stock for a rapid delivery service. Other colours are available on request.

Benefits

- **Smooth matt colour**
- **Wide choice of colours**
- **Ten year colour stability**
- **Good scratch and impact resistance**
- **Lamina Class 'O'**
- **Low maintenance**
- **Thermally efficient**
- **Resistant to moisture**

